

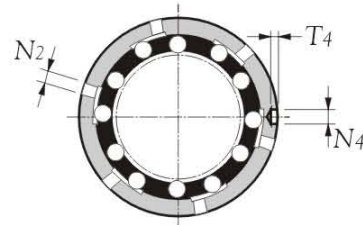

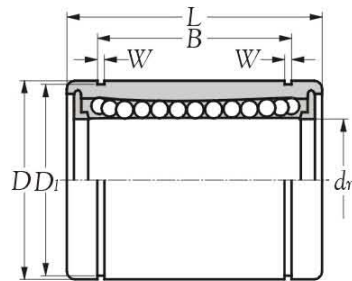

BALL BUSHING

LINEAR BALL BEARINGS
SERIES **LME..**



Boundary dimensions d mm	Bearing number				Number of ball tracks	Principal dimensions					
	standard steel retainer	standard resin retainer	with seals steel retainer	with seals resin retainer		d_r		D		L	
						mm	0.001mm	mm	0.001mm	mm	mm
5	-	LME 5	-	LME 5 UU AS	3	5	(+8/0)	12	(0/-8)	22	(0/-0.2)
8	LME 8 A AS	LME 8	LME 8 A UU AS	LME 8 UU AS	4	8	(+8/0)	16	(0/-8)	25	(0/-0.2)
10	LME 10 A AS	-	LME 10 A UU AS	-	4	10	(+8/0)	19	(0/-9)	29	(0/-0.2)
12	LME 12 A AS	LME 12	LME 12 A UU AS	LME 12 UU AS	4	12	(+8/0)	22	(0/-9)	32	(0/-0.2)
16	LME 16 A AS	LME 16	LME 16 A UU AS	LME 16 UU AS	5	16	(+9/-1)	26	(0/-9)	36	(0/-0.2)
20	LME 20 A AS	LME 20	LME 20 A UU AS	LME 20 UU AS	5	20	(+9/-1)	32	(0/-11)	45	(0/-0.2)
25	LME 25 A AS	LME 25	LME 25 A UU AS	LME 25 UU AS	6	25	(+11/-1)	40	(0/-11)	58	(0/-0.3)
30	LME 30 A AS	LME 30	LME 30 A UU AS	LME 30 UU AS	6	30	(+11/-1)	47	(0/-11)	68	(0/-0.3)
40	LME 40 A AS	LME 40	LME 40 A UU AS	LME 40 UU AS	6	40	(+13/-2)	62	(0/-13)	80	(0/-0.3)
50	LME 50 A AS	LME 50	LME 50 A UU AS	LME 50 UU AS	6	50	(+13/-2)	75	(0/-13)	100	(0/-0.3)
60	LME 60 A AS	LME 60	LME 60 A UU AS	LME 60 UU AS	6	60	(+13/-2)	90	(0/-15)	125	(0/-0.4)



Technical supplement

	Cages	Precision	Grease
Steel -	Nil		
Polymid -	Nil	Normal (ISO)	Nil
Brass -	Nil		

Remark: If you have more inquiry of technical, please inquire
NIKO web-site: [Http://www.nipponkodobearings.com](http://www.nipponkodobearings.com)

LINEAR BALL BEARINGS
SERIES LME..

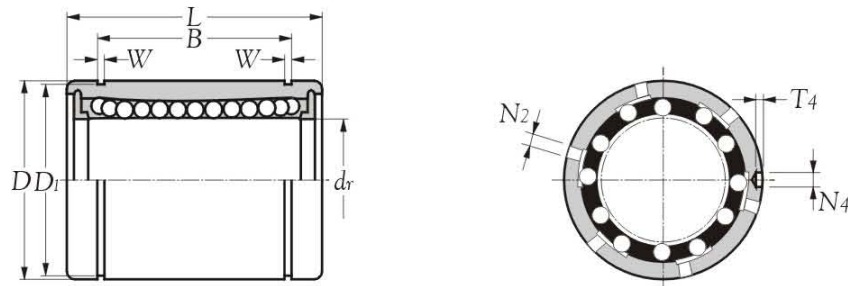

Principal dimensions			Roundness	Steel retainer maximum radial clearance	Resin retainer maximum radial clearance	Load ratings		Mass		
B tolerance	W	D ₁				dynamic C	static C ₀	steel retainer	resin retainer	
mm			0.001mm	0.001mm	0.001mm	N		kg(s).		
14.5	(0/-0.2)	1.10	11.5	12	-	-5	206	265	-	0.011
16.5	(0/-0.2)	1.10	15.2	12	-3	-5	265	402	0.022	0.020
22.0	(0/-0.2)	1.30	18.0	12	-4	-	372	549	0.036	-
22.9	(0/-0.2)	1.30	21.0	12	-4	-7	510	784	0.045	0.041
24.9	(0/-0.2)	1.30	24.9	12	-4	-7	578	892	0.060	0.065
31.5	(0/-0.2)	1.60	30.3	15	-6	-9	862	1370	0.102	0.091
44.1	(0/-0.3)	1.85	37.5	15	-6	-9	980	1570	0.235	0.215
52.1	(0/-0.3)	1.85	44.5	15	-8	-9	1570	2740	0.360	0.325
60.6	(0/-0.3)	2.15	59.0	17	-8	-13	2160	4020	0.770	0.705
77.6	(0/-0.3)	2.65	72.0	17	-13	-13	3820	7940	1.250	1.130
101.7	(0/-0.4)	3.15	86.5	20	-13	-16	4700	9800	2.220	2.220

LINEAR BALL BEARINGS
 SERIES **LME..AJ AS**

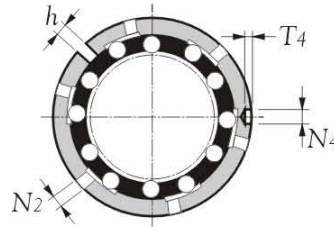
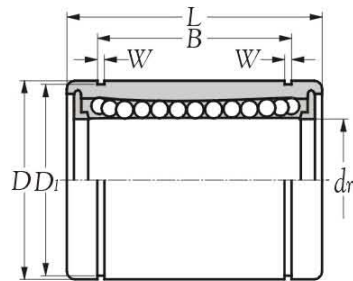

Boundary dimensions <i>d</i> mm	Bearing number				Number of ball tracks	Principal dimensions			
	standard steel retainer	standard resin retainer	with seals steel retainer	with seals resin retainer		<i>d_r</i> tolerance		<i>D</i> tolerance	
					mm	0.001mm	mm	0.001mm	
5	-	LME 5 AJ AS	-	LME 5 UUAJ AS	3	5	(+8/0)	12	(0/-8)
8	-	LME 8 AJ AS	-	LME 8 UUAJ AS	4	8	(+8/0)	16	(0/-8)
12	LME 12 A-AJ AS	LME 12 AJ AS	LME 12 A-UUAJ AS	LME 12 UUAJ AS	4	12	(+8/0)	22	(0/-9)
16	LME 16 A-AJ AS	LME 16 AJ AS	LME 16 A-UUAJ AS	LME 16 UUAJ AS	5	16	(+9/-1)	26	(0/-9)
20	LME 20 A-AJ AS	LME 20 AJ AS	LME 20 A-UUAJ AS	LME 20 UUAJ AS	5	20	(+9/-1)	32	(0/-11)
25	LME 25 A-AJ AS	LME 25 AJ AS	LME 25 A-UUAJ AS	LME 25 UUAJ AS	6	25	(+11/-1)	40	(0/-11)
30	LME 30 A-AJ AS	LME 30 AJ AS	LME 30 A-UUAJ AS	LME 30 UUAJ AS	6	30	(+11/-1)	47	(0/-11)
40	LME 40 A-AJ AS	LME 40 AJ AS	LME 40 A-UUAJ AS	LME 40 UUAJ AS	6	40	(+13/-2)	62	(0/-13)
50	LME 50 A-AJ AS	LME 50 AJ AS	LME 50 A-UUAJ AS	LME 50 UUAJ AS	6	50	(+13/-2)	75	(0/-13)
60	LME 60 A-AJ AS	LME 60 AJ AS	LME 60 A-UUAJ AS	LME 60 UUAJ AS	6	60	(+13/-2)	90	(0/-15)



Technical supplement

Cages	Precision	Grease
Steel - Nil		
Polymid - Nil	Normal (ISO)	Nil
Brass - Nil		

Remark: If you have more inquiry of technical, please inquire
 NIKO web-site: <http://www.nipponkodobearings.com>

LINEAR BALL BEARINGS
SERIES LME..AJ AS

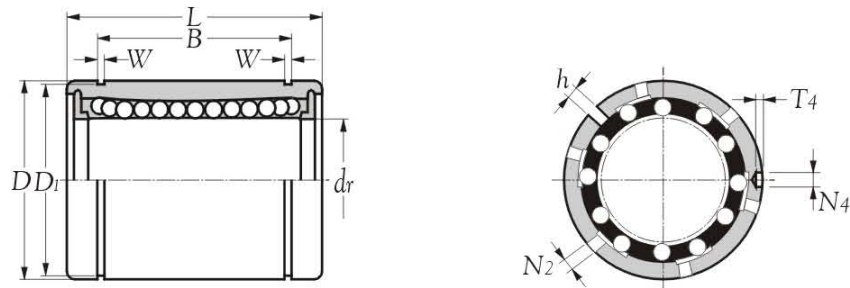

L	Principal dimensions					Roundness	Steel retainer maximum radial clearance	Resin retainer maximum radial clearance	Load ratings		Mass		
	tolerance	B	W	D ₁	h				dynamic C	static C ₀	steel retainer	resin retainer	
mm	mm	mm	mm	mm	mm	0.001mm	0.001mm	0.001mm	N		kg(s).		
22	(0/-0.2)	14.5	(0/-0.2)	1.10	11.5	1.0	12	-	-5	206	265	0.011	-
25	(0/-0.2)	16.5	(0/-0.2)	1.10	15.2	1.0	12	-3	-5	265	402	0.020	0.022
32	(0/-0.2)	22.9	(0/-0.2)	1.30	21.0	1.5	12	-4	-7	510	784	0.041	0.045
36	(0/-0.2)	24.9	(0/-0.2)	1.30	24.9	1.5	12	-4	-7	578	892	0.065	0.060
45	(0/-0.2)	31.5	(0/-0.2)	1.60	30.3	2.0	15	-6	-9	862	1370	0.091	0.102
58	(0/-0.3)	44.1	(0/-0.3)	1.85	37.5	2.0	15	-6	-9	980	1570	0.215	0.235
68	(0/-0.3)	52.1	(0/-0.3)	1.85	44.5	2.0	15	-8	-9	1570	2740	0.325	0.360
80	(0/-0.3)	60.6	(0/-0.3)	2.15	59.0	3.0	17	-8	-13	2160	4020	0.705	0.770
100	(0/-0.3)	77.6	(0/-0.3)	2.65	72.0	3.0	17	-13	-13	3820	7940	1.130	1.250
125	(0/-0.4)	101.7	(0/-0.4)	3.15	86.5	3.0	20	-13	-16	4700	9800	2.220	2.220

LINEAR BALL BEARINGS
SERIES **LME..OP**

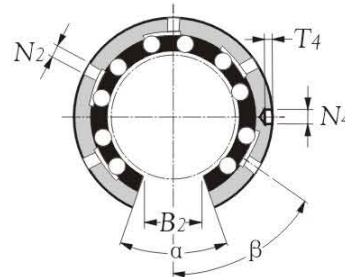
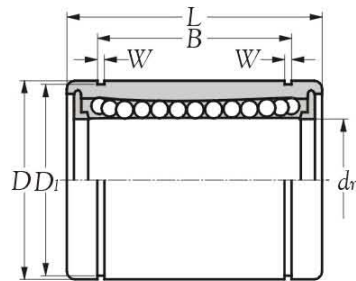

Boundary dimensions <i>d</i> mm	Bearing number				Number of ball tracks	Principal dimensions			
	standard steel retainer	standard resin retainer	with seals steel retainer	with seals resin retainer		<i>d_r</i>		<i>D</i>	
						mm	0.001mm	mm	0.001mm
12	LME 12 A OP	LME 12 OP AS	LME 12 A UUOP AS	LME 12 UUOP AS	3	12	(+8/0)	22	(0/-9)
16	LME 16 A OP	LME 16 OP AS	LME 16 A UUOP AS	LME 16 UUOP AS	4	16	(+9/-1)	26	(0/-9)
20	LME 20 A OP	LME 20 OP AS	LME 20 A UUOP AS	LME 20 UUOP AS	4	20	(+9/-1)	32	(0/-11)
25	LME 25 A OP	LME 25 OP AS	LME 25 A UUOP AS	LME 25 UUOP AS	5	25	(+11/-1)	40	(0/-11)
30	LME 30 A OP	LME 30 OP AS	LME 30 A UUOP AS	LME 30 UUOP AS	5	30	(+11/-1)	47	(0/-11)
40	LME 40 A OP	LME 40 OP AS	LME 40 A UUOP AS	LME 40 UUOP AS	5	40	(+13/-2)	62	(0/-13)
50	LME 50 A OP	LME 50 OP AS	LME 50 A UUOP AS	LME 50 UUOP AS	5	50	(+13/-2)	75	(0/-13)
60	LME 60 A OP	LME 60 OP AS	LME 60 A UUOP AS	LME 60 UUOP AS	5	60	(+13/-2)	90	(0/-15)



Technical supplement

	Cages	Precision	Grease
Steel -	Nil		
Polymid -	Nil	Normal (ISO)	
Brass -	Nil		Nil

Remark: If you have more inquiry of technical, please inquire
NIKO web-site: [Http://www.nipponkodobearings.com](http://www.nipponkodobearings.com)

LINEAR BALL BEARINGS
SERIES LME..OP

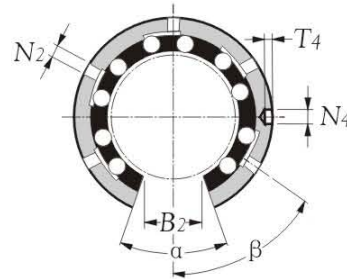
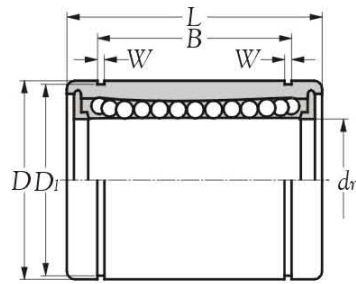

L	Principal dimensions						Roundness	Steel retainer maximum radial clearance	Resin retainer maximum radial clearance	Load ratings		Mass		
	tolerance	B	W	D_1	h_1	θ				dynamic C	static C_0	steel retainer	resin retainer	
mm	mm	mm	mm	mm	mm	°	0.001mm	0.001mm	0.001mm	N	N	kg(s).	kg(s).	
32	(0/-0.2)	22.9	(0/-0.2)	1.30	21.0	7.5	78°	12	-4	-7	510	784	0.045	0.041
36	(0/-0.2)	24.9	(0/-0.2)	1.30	24.9	10.0	78°	12	-4	-7	578	892	0.060	0.065
45	(0/-0.2)	31.5	(0/-0.2)	1.60	30.3	10.0	60°	15	-6	-9	862	1370	0.102	0.091
58	(0/-0.3)	44.1	(0/-0.3)	1.85	37.5	12.5	60°	15	-6	-9	980	1570	0.235	0.215
68	(0/-0.3)	52.1	(0/-0.3)	1.85	44.5	12.5	50°	15	-8	-9	1570	2740	0.360	0.325
80	(0/-0.3)	60.6	(0/-0.3)	2.15	59.0	16.8	50°	17	-8	-13	2160	4020	0.770	0.705
100	(0/-0.4)	77.6	(0/-0.4)	2.65	72.0	21.0	50°	17	-13	-13	3820	7940	1.250	1.130
125	(0/-0.4)	101.7	(0/-0.4)	3.15	86.5	27.2	54°	20	-13	-16	4700	9800	2.220	2.220

LINEAR BALL BEARINGS
SERIES **LME..F**

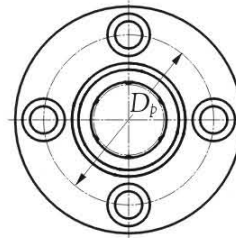
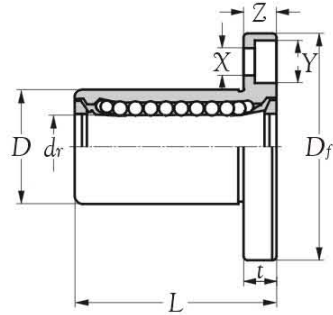

Boundary dimensions <i>d</i> mm	Bearing number		Number of ball tracks	Principal dimensions					
	standard resin retainer	with seals resin retainer		<i>dr</i>		<i>D</i>		<i>L</i>	
				tolerance mm	0.001mm	tolerance mm	0.001mm	tolerance mm	mm
8	LMEF 8	LMEF 8 UU	4	8	(+8/0)	16	(0/-13)	25	(±0.3)
12	LMEF 12	LMEF 12 UU	4	12	(+8/0)	22	(0/-16)	32	(±0.3)
16	LMEF 16	LMEF 16 UU	5	16	(+9/-1)	26	(0/-16)	36	(±0.3)
20	LMEF 20	LMEF 20 UU	5	20	(+9/-1)	32	(0/-19)	45	(±0.3)
25	LMEF 25	LMEF 25 UU	6	25	(+11/-1)	40	(0/-19)	58	(±0.3)
30	LMEF 30	LMEF 30 UU	6	30	(+11/-1)	47	(0/-19)	68	(±0.3)
40	LMEF 40	LMEF 40 UU	6	40	(+13/-2)	62	(0/-22)	80	(±0.3)
50	LMEF 50	LMEF 50 UU	6	50	(+13/-2)	75	(0/-22)	100	(±0.3)
60	LMEF 60	LMEF 60 UU	6	60	(+13/-2)	90	(0/-25)	125	(±0.3)



Technical supplement

Cages	Precision	Grease
Steel - Nil	Normal (ISO)	Nil
Polymid - Nil		
Brass - Nil		

Remark: If you have more inquiry of technical, please inquire
NIKO web-site: [Http://www.nipponkodobearings.com](http://www.nipponkodobearings.com)

LINEAR BALL BEARINGS
SERIES LME..F

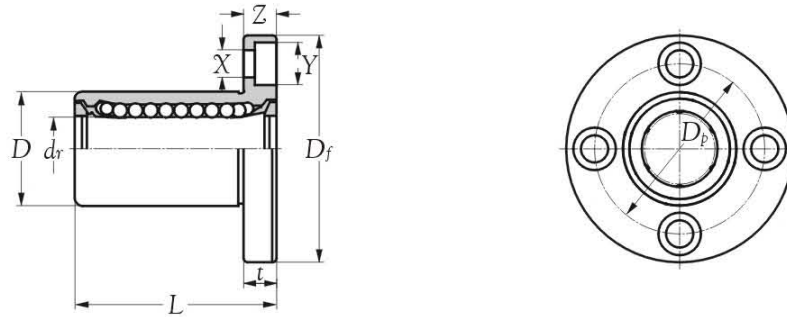

D_f	Principa dimensions flange			Roundness 0.001mm	Squareness 0.001mm	Load ratings		Mass kg(s). (approx.)
	t	D_p	$XxYxZ$			dynamic C	static C_o	
	mm					N		
32	5	24	3.5 x 6.0 x 3.1	12	12	265	402	0.041
42	6	32	4.5 x 7.5 x 4.1	12	12	510	784	0.080
46	6	36	4.5 x 7.5 x 4.1	12	12	578	892	0.103
54	8	43	5.5 x 9.0 x 5.1	15	15	862	1370	0.182
62	8	51	5.5 x 9.0 x 5.1	15	15	980	1570	0.335
76	10	62	6.6 x 11 x 6.1	15	15	1570	2740	0.560
98	13	80	9.0 x 14 x 8.1	17	17	2160	4020	1.175
112	13	94	9.0 x 14 x 8.1	17	17	3820	7940	1.745
134	18	112	11 x 17 x 11.1	20	20	4700	9800	3.220

LINEAR BALL BEARINGS
SERIES **LME..K**

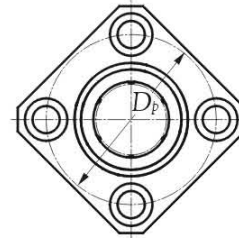
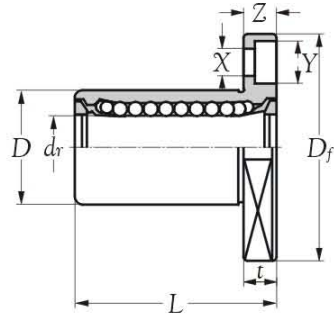

Boundary dimensions mm	Bearing number		Number of ball tracks	Principal dimensions					
	standard resin retainer	with seals resin retainer		d_r		D		L	
				mm	0.001mm	mm	0.001mm	mm	mm
8	LMEK 8	LMEK 8 UU	4	8	(+8/0)	16	(0/-13)	25	(±0.3)
12	LMEK 12	LMEK 12 UU	4	12	(+8/0)	22	(0/-16)	32	(±0.3)
16	LMEK 16	LMEK 16 UU	5	16	(+9/-1)	26	(0/-16)	36	(±0.3)
20	LMEK 20	LMEK 20 UU	5	20	(+9/-1)	32	(0/-19)	45	(±0.3)
25	LMEK 25	LMEK 25 UU	6	25	(+11/-1)	40	(0/-19)	58	(±0.3)
30	LMEK 30	LMEK 30 UU	6	30	(+11/-1)	47	(0/-19)	68	(±0.3)
40	LMEK 40	LMEK 40 UU	6	40	(+13/-2)	62	(0/-22)	80	(±0.3)
50	LMEK 50	LMEK 50 UU	6	50	(+13/-2)	75	(0/-22)	100	(±0.3)
60	LMEK 60	LMEK 60 UU	6	60	(+13/-2)	90	(0/-25)	125	(±0.3)



Technical supplement

Cages	Precision	Grease
Steel - Nil	Normal (ISO)	Nil
Polymid - Nil		
Brass - Nil		

Remark: If you have more inquiry of technical, please inquire
NIKO web-site: [Http://www.nipponkodobearings.com](http://www.nipponkodobearings.com)

LINEAR BALL BEARINGS
SERIES LME..K

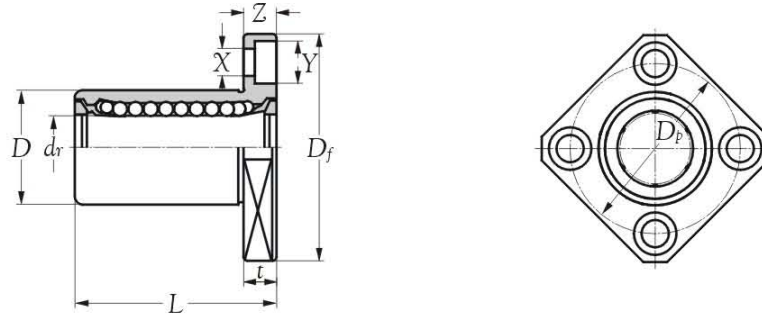

D_f	Principa dimensions flange			Roundness 0.001mm	Squareness 0.001mm	Load ratings		Mass kg(s). (approx.)
	t	D_p	$XxYxZ$			dynamic C	static C_o	
	mm					N		
32	5	24	3.5 x 6.0 x 3.1	12	12	265	402	0.041
42	6	32	4.5 x 7.5 x 4.1	12	12	510	784	0.080
46	6	36	4.5 x 7.5 x 4.1	12	12	578	892	0.103
54	8	43	5.5 x 9.0 x 5.1	15	15	862	1370	0.182
62	8	51	5.5 x 9.0 x 5.1	15	15	980	1570	0.335
76	10	62	6.6 x 11 x 6.1	15	15	1570	2740	0.560
98	13	80	9.0 x 14 x 8.1	17	17	2160	4020	1.175
112	13	94	9.0 x 14 x 8.1	17	17	3820	7940	1.745
134	18	112	11.0 x 17 x 11.1	20	20	4700	9800	3.220

SUPER BALL BUSHINGS
SERIES LMES

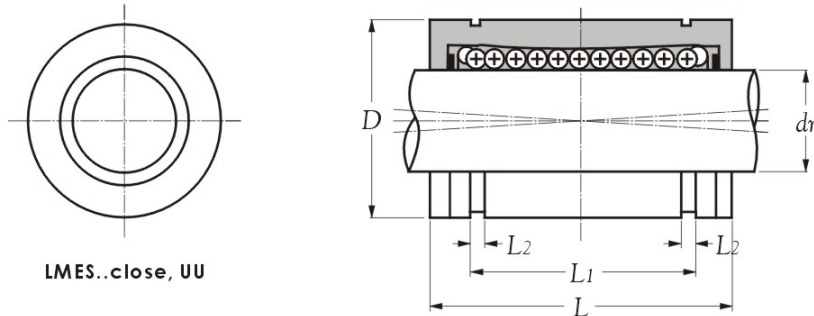

LMES..close, UU

Boundary dimensions <i>d</i> mm	Bearing number		Number of ball tracks	Principal dimensions						Load ratings		Mass kg. (approx.)
				<i>d_r</i> tolerance mm 0.001mm	<i>D</i> ±0.1	<i>L</i> ±0.2	<i>L₁</i> ±0.2	<i>L₂</i> min.	dynamic C	static C ₀		
10	LMES 10	LMES 10 UU	5	10	+8 ~ 0	19	29	21.7	1.35	750	550	0.017
12	LMES 12	LMES 12 UU	5	12	+8 ~ 0	22	32	22.7	1.35	1230	1100	0.023
16	LMES 16	LMES 16 UU	5	16	+9 ~ 1	26	36	24.7	1.35	1550	1250	0.028
20	LMES 20	LMES 20 UU	6	20	+9 ~ 1	32	45	31.3	1.65	2580	1670	0.061
25	LMES 25	LMES 25 UU	6	25	+11 ~ 1	40	58	43.8	1.90	3800	2750	0.122
30	LMES 30	LMES 30 UU	6	30	+11 ~ 1	47	68	51.8	1.90	4710	2800	0.185
40	LMES 40	LMES 40 UU	6	40	+13 ~ 2	62	80	60.4	2.20	6500	5720	0.360
50	LMES 50	LMES 50 UU	6	50	+13 ~ 2	75	100	77.4	2.70	11460	7940	0.580



Technical supplement

Gages	Precision	Grease
Steel - Nil		
Polymid - Nil	Normal (ISO)	Nil
Brass - Nil		

Remark: If you have more inquiry of technical, please inquire
NIKO web-site: [Http://www.nipponkodobearings.com](http://www.nipponkodobearings.com)

SUPER BALL BUSHINGS
SERIES LMES..OP

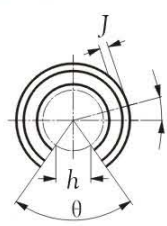

LMES 12 OP

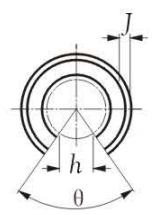
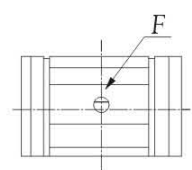

LMES 16 OP, LMES 20 OP

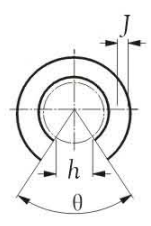
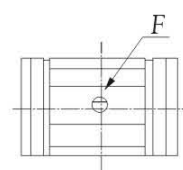

LMES 25 OP

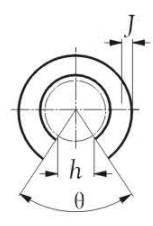
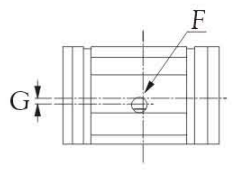

LMES 30 OP, LMES 40 OP, LMES 50 OP

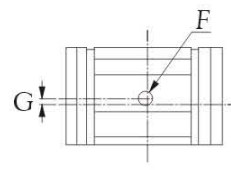

Boundary dimensions <i>d</i> mm	Bearing number		Number of ball tracks	Principal dimensions								Load ratings		Mass kg. (approx.)
	<i>D</i> ±0.1	<i>L</i> ±0.2		<i>L</i> ₂	<i>h</i>	θ°	<i>F</i>	<i>G</i>	<i>J</i>	dynamic <i>C</i>	static <i>C</i> ₀			
12	LMES 12OP	LMES 12UUOP	4	22	32	1.35	6.5	66	3.0	-	0.7	1290	1260	0.018
16	LMES 16OP	LMES 16UUOP	4	26	36	1.35	9.0	68	3.0	-	0.7	1640	1320	0.022
20	LMES 20OP	LMES 20UUOP	5	32	45	1.65	9.0	55	3.0	-	0.9	2630	1720	0.051
25	LMES 25OP	LMES 25UUOP	5	40	58	1.90	11.5	57	3.0	1.5	1.4	3910	2850	0.102
30	LMES 30OP	LMES 30UUOP	5	47	68	1.90	14.0	57	3.0	2.0	2.2	4850	2900	0.155
40	LMES 40OP	LMES 40UUOP	5	62	80	2.20	19.5	56	3.0	1.5	2.7	6700	5900	0.300
50	LMES 50OP	LMES 50UUOP	5	75	100	2.70	22.5	54	3.0	2.5	2.3	11700	8100	0.480



Technical supplement

Cages	Precision	Grease
Steel - Nil	Normal (ISO)	Nil
Polymid - Nil		
Brass - Nil		

Remark: If you have more inquiry of technical, please inquire
 NIKO web-site: [Http://www.nipponkodobearings.com](http://www.nipponkodobearings.com)

LINEAR BALL BEARINGS
SERIES KH

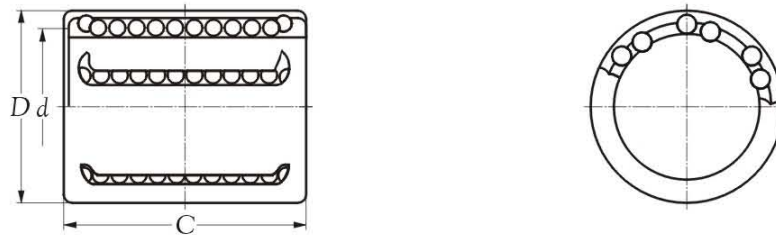

Boundary dimensions <i>d</i> mm	Bearing number	Number of ball tracks	Principal dimensions		Basic load ratings		Max runout speed		Mass kg. (approx.)
			<i>D</i> mm	<i>C</i> mm	dynamic <i>C</i> N	static <i>C₀</i> N	grease oil	r/min	
6	KH 0622	4	12	22	400	239	41	24	0.0070
6	KH 0622 PP	4	12	22	400	239	41	24	0.0070
8	KH 0824	4	15	24	435	280	44	29	0.0120
8	KH 0824 PP	4	15	24	435	280	44	29	0.0120
10	KH 1026	4	17	26	500	370	51	38	0.0145
10	KH 1026 PP	4	17	26	500	370	51	38	0.0145
12	KH 1228	5	19	28	620	510	63	52	0.0185
12	KH 1228 PP	5	19	28	620	510	63	52	0.0185
14	KH 1428	5	21	28	620	520	63	53	0.0205
14	KH 1428 PP	5	21	28	620	520	63	53	0.0205
16	KH 1630	5	24	30	800	620	82	63	0.0275
16	KH 1630 PP	5	24	30	800	620	82	63	0.0275
20	KH 2030	6	28	30	950	790	97	81	0.0325
20	KH 2030 PP	6	28	30	950	790	97	81	0.0325
25	KH 2540	6	35	40	1990	1670	203	170	0.0660
25	KH 2540 PP	6	35	40	1990	1670	203	170	0.0660
30	KH 3050	7	40	50	2800	2700	285	275	0.0950
30	KH 3050 PP	7	40	50	2800	2700	285	275	0.0950
40	KH 4060	8	52	60	4400	4450	449	454	0.1820
40	KH 4060 PP	8	52	60	4400	4450	449	454	0.1820
50	KH 5070	9	62	70	5500	6300	561	642	0.2520
50	KH 5070 PP	9	62	70	5500	6300	561	642	0.2520



Technical supplement

Cages	Precision	Grease
Steel - Nil	Normal (ISO)	Nil
Polymid - Nil		
Brass - Nil		

Remark: If you have more inquiry of technical, please inquire
NIKO web-site: [Http://www.nipponkodobearings.com](http://www.nipponkodobearings.com)



**ALUMINIUM HOUSINGS
& COMPLETE UNITS**

ALUMINIUM HOUSINGS
SERIES **FGWA**

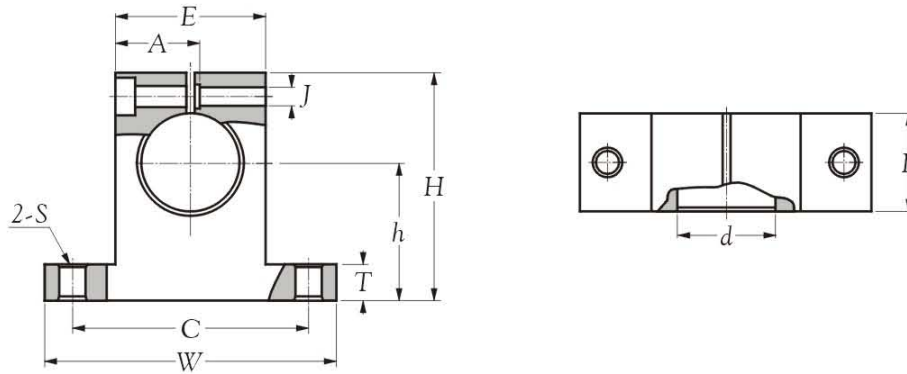

Boundary dimensions <i>d</i> mm	Bearing number	Principal dimensions											Mass kg. (approx.)
		<i>d</i>	<i>W</i>	<i>C</i>	<i>H</i>	<i>L</i>	<i>h</i>	<i>T</i>	<i>E</i>	<i>A</i>	<i>J</i>	<i>S</i>	
		tolerance mm 0.001mm	tolerance mm 0.001mm	tolerance mm 0.001mm	tolerance mm 0.001mm	tolerance mm 0.001mm	tolerance mm 0.001mm	tolerance mm 0.001mm	mm				
12	FGWA 12	12 ^{+0.018} / ₀	42 32	±0.15	35 ±0.30	12 ±0.20	20 ±0.020	5.5	20	12.0	M3	5.5	0.024
16	FGWA 16	16 ^{+0.018} / ₀	50 40	±0.15	42 ±0.30	16 ±0.20	25 ±0.020	6.5	28	16.0	M3	5.5	0.050
20	FGWA 20	20 ^{+0.021} / ₀	60 45	±0.15	50 ±0.30	20 ±0.20	30 ±0.020	8.0	32	18.0	M4	5.5	0.080
25	FGWA 25	25 ^{+0.021} / ₀	74 60	±0.15	58 ±0.30	25 ±0.20	35 ±0.020	9.0	38	21.0	M5	6.6	0.132
30	FGWA 30	30 ^{+0.021} / ₀	84 68	±0.15	68 ±0.30	28 ±0.20	40 ±0.020	10.0	45	24.5	M6	9.0	0.200
40	FGWA 40	40 ^{+0.025} / ₀	108 86	±0.15	86 ±0.30	32 ±0.20	50 ±0.020	12.0	56	31.0	M8	11.0	0.350



Technical supplement

Cages	Precision	Grease
Steel - Nil		
Polymid - Nil	Normal (ISO)	Nil
Brass - Nil		

Remark: If you have more inquiry of technical, please inquire
NIKO web-site: [Http://www.nipponkodobearings.com](http://www.nipponkodobearings.com)

ALUMINIUM HOUSINGS
SERIES **SB..AS**

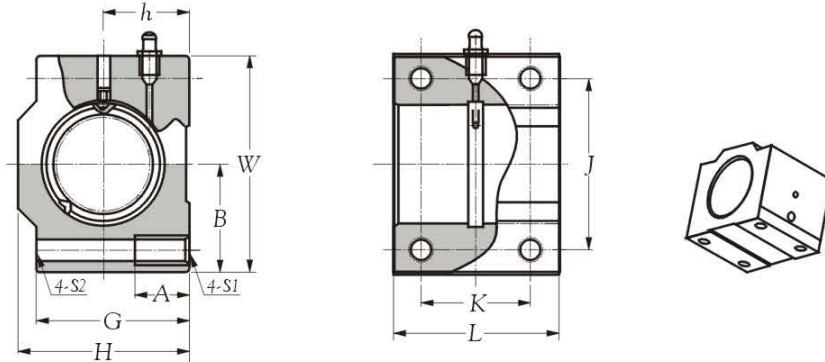

Bearing number	Principal dimensions										Mass kg(s). (approx.)	
	<i>h</i>	<i>B</i>	<i>W</i>	<i>H</i>	<i>G</i>	<i>A</i>	<i>J</i>	<i>S1</i>	<i>S2</i>	<i>K</i>		<i>L</i>
	tolerance mm 0.001mm	tolerance mm 0.001mm	tolerance mm 0.001mm	tolerance mm 0.001mm	tolerance mm 0.001mm	tolerance mm 0.001mm	tolerance mm 0.001mm			tolerance mm 0.001mm		tolerance mm 0.001mm
SB 16 AS	22 ±0.02	26.5 ±0.02	53 0 ~ -0.3	42 0 ~ -0.3	37.0	13	40 ±0.15	M6	5.3	26 ±0.15	36 0 ~ -0.2	0.202
SB 20 AS	25 ±0.02	30.0 ±0.02	60 0 ~ -0.3	50 0 ~ -0.3	44.0	18	45 ±0.15	M8	6.6	32 ±0.15	45 0 ~ -0.2	0.301
SB 25 AS	35 ±0.02	39.0 ±0.02	78 0 ~ -0.3	60 0 ~ -0.3	52.5	26	60 ±0.15	M10	8.4	40 ±0.15	58 0 ~ -0.2	0.659
SB 30 AS	35 ±0.02	43.5 ±0.02	87 0 ~ -0.3	70 0 ~ -0.3	62.5	26	68 ±0.15	M10	8.4	45 ±0.15	68 0 ~ -0.2	1.000
SB 40 AS	45 ±0.02	54.0 ±0.01	108 0 ~ -0.3	90 0 ~ -0.3	80.0	26	86 ±0.15	M12	10.5	58 ±0.15	80 0 ~ -0.2	2.233

SERIES **SB LME..**

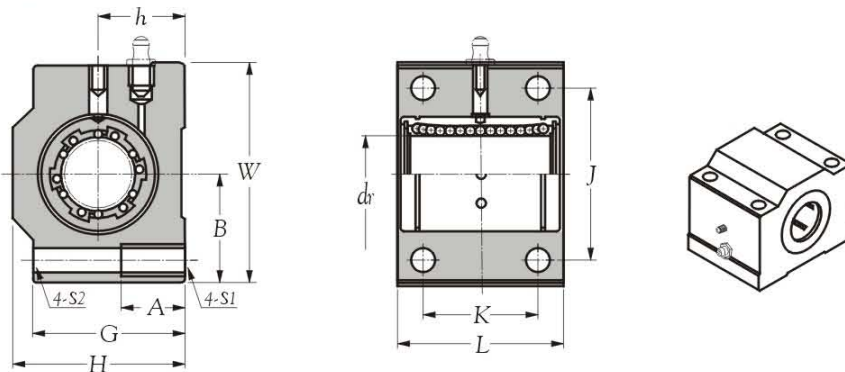

Bearing number	Principal dimensions										Mass kg(s). (approx.)	
	<i>h</i>	<i>B</i>	<i>W</i>	<i>H</i>	<i>G</i>	<i>A</i>	<i>J</i>	<i>S1</i>	<i>S2</i>	<i>K</i>		<i>L</i>
	tolerance mm 0.001mm	tolerance mm 0.001mm	tolerance mm 0.001mm	tolerance mm 0.001mm	tolerance mm 0.001mm	tolerance mm 0.001mm	tolerance mm 0.001mm			tolerance mm 0.001mm		tolerance mm 0.001mm
SB LME 16 UUAS	22 ±0.02	26.5 ±0.02	53 0 ~ -0.3	42 0 ~ -0.3	37.0	13	40 ±0.15	M6	5.3	26 ±0.15	36 0 ~ -0.2	0.202
SB LME 20 UUAS	25 ±0.02	30.0 ±0.02	60 0 ~ -0.3	50 0 ~ -0.3	44.0	18	45 ±0.15	M8	6.6	32 ±0.15	45 0 ~ -0.2	0.301
SB LME 25 UUAS	35 ±0.02	39.0 ±0.02	78 0 ~ -0.3	60 0 ~ -0.3	52.5	26	60 ±0.15	M10	8.4	40 ±0.15	58 0 ~ -0.2	0.659
SB LME 30 UUAS	35 ±0.02	43.5 ±0.02	87 0 ~ -0.3	70 0 ~ -0.3	62.5	26	68 ±0.15	M10	8.4	45 ±0.15	68 0 ~ -0.2	1.000
SB LME 40 UUAS	45 ±0.02	54.0 ±0.01	108 0 ~ -0.3	90 0 ~ -0.3	80.0	26	86 ±0.15	M12	10.5	58 ±0.15	80 0 ~ -0.2	2.233

Technical supplement

	Cages	Precision	Grease
	Steel - Nil		
	Polymid - Nil	Normal (ISO)	
	Brass - Nil		Nil

Remark: If you have more inquiry of technical, please inquire
NIKO web-site: [Http://www.nipponkodobearings.com](http://www.nipponkodobearings.com)

ALUMINIUM HOUSINGS
SERIES **SO..AS**

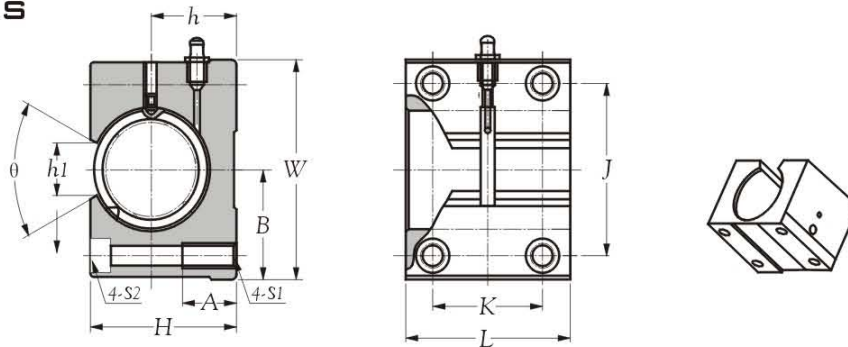

Bearing number	Principal dimensions												Mass kg(s). (approx.)
	h	B	W	H	A	J	S_1	S_2	K	L	h_1	θ	
	tolerance mm 0.001mm	tolerance mm 0.001mm	tolerance mm 0.001mm	tolerance mm 0.001mm	tolerance mm 0.001mm	tolerance mm 0.001mm	tolerance mm 0.001mm	tolerance mm 0.001mm	tolerance mm 0.001mm	tolerance mm 0.001mm	tolerance mm 0.001mm	tolerance mm 0.001mm	
SO 16 AS	22 ± 0.02	26.5 ± 0.02	53 0~-0.3	35 0~-0.3	13	40 ± 0.15	M6	5.3	26 ± 0.15	36 0~-0.2	16.4 ± 0.3	78°	0.159
SO 20 AS	25 ± 0.02	30.0 ± 0.02	60 0~-0.3	42 0~-0.3	18	45 ± 0.15	M8	6.5	32 ± 0.15	45 0~-0.2	16.0 ± 0.3	60°	0.259
SO 25 AS	35 ± 0.02	39.0 ± 0.02	78 0~-0.3	51 0~-0.3	22	60 ± 0.15	M10	8.5	40 ± 0.15	58 0~-0.2	20.0 ± 0.3	60°	0.574
SO 30 AS	35 ± 0.02	43.5 ± 0.02	87 0~-0.3	60 0~-0.3	22	68 ± 0.15	M10	8.5	45 ± 0.15	68 0~-0.2	19.9 ± 0.3	50°	1.453
SO 40 AS	45 ± 0.02	54.0 ± 0.01	108 0~-0.3	77 0~-0.3	26	86 ± 0.15	M12	10.5	58 ± 0.15	80 0~-0.2	26.1 ± 0.3	50°	1.996

SERIES **SO LME..**

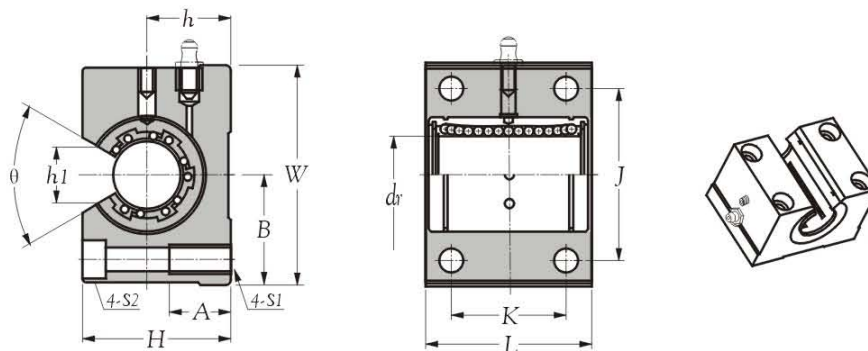

Bearing number	Principal dimensions												Mass kg(s). (approx.)
	h	B	W	H	A	J	S_1	S_2	K	L	h_1	θ	
	tolerance mm 0.001mm	tolerance mm 0.001mm	tolerance mm 0.001mm	tolerance mm 0.001mm	tolerance mm 0.001mm	tolerance mm 0.001mm	tolerance mm 0.001mm	tolerance mm 0.001mm	tolerance mm 0.001mm	tolerance mm 0.001mm	tolerance mm 0.001mm	tolerance mm 0.001mm	
SO LME 16 UUOP AS	22 ± 0.02	26.5 ± 0.02	53 0~-0.3	35 0~-0.3	13	40 ± 0.15	M6	5.3	26 ± 0.15	36 0~-0.2	16.4 ± 0.3	78°	0.159
SO LME 20 UUOP AS	25 ± 0.02	30.0 ± 0.02	60 0~-0.3	42 0~-0.3	18	45 ± 0.15	M8	6.5	32 ± 0.15	45 0~-0.2	16.0 ± 0.3	60°	0.259
SO LME 25 UUOP AS	35 ± 0.02	39.0 ± 0.02	78 0~-0.3	51 0~-0.3	22	60 ± 0.15	M10	8.5	40 ± 0.15	58 0~-0.2	20.0 ± 0.3	60°	0.574
SO LME 30 UUOP AS	35 ± 0.02	43.5 ± 0.02	87 0~-0.3	60 0~-0.3	22	68 ± 0.15	M10	8.5	45 ± 0.15	68 0~-0.2	19.9 ± 0.3	50°	1.453
SO LME 40 UUOP AS	45 ± 0.02	54.0 ± 0.01	108 0~-0.3	77 0~-0.3	26	86 ± 0.15	M12	10.5	58 ± 0.15	80 0~-0.2	26.1 ± 0.3	50°	1.996

Technical supplement

	Cages	Precision	Grease
Steel - Nil	Polymid - Nil	Brass - Nil	Normal (ISO)
			Nil

Remark: If you have more inquiry of technical, please inquire
NIKO web-site: [Http://www.nipponkodobearings.com](http://www.nipponkodobearings.com)

ALUMINIUM HOUSINGS
SERIES S2B..N

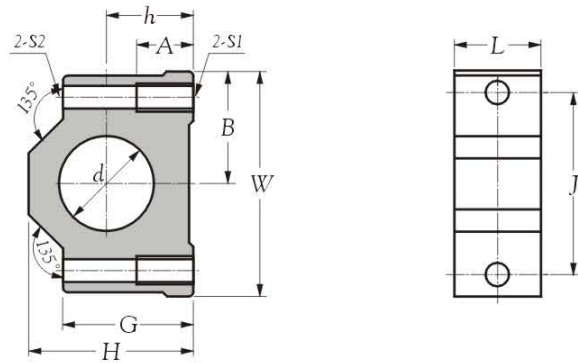

Boundary dimensions d mm	Bearing number	Principal dimensions										Mass kg. (approx.)		
		h		B		W	H	A	J		S1		S2	L
		mm	0.001mm	mm	0.001mm	mm	mm	mm	mm	0.001mm	mm		mm	mm
22	S2B 12 N	20	+0.010 ~ -0.014	26.0	±0.015	52	38	13	42	±0.15	M6	5.3	20	0.025
26	S2B 16 N	20	+0.010 ~ -0.014	28.0	±0.015	56	40	13	46	±0.15	M6	5.3	22	0.060
32	S2B 20 N	25	+0.010 ~ -0.014	35.0	±0.015	70	50	15	58	±0.20	M8	6.6	28	0.098
40	S2B 25 N	30	+0.010 ~ -0.014	40.0	±0.015	80	60	18	68	±0.15	M8	6.6	40	0.125
47	S2B 30 N	35	+0.010 ~ -0.014	44.0	±0.015	88	70	18	76	±0.15	M8	6.6	48	0.140
62	S2B 40 N	45	+0.010 ~ -0.014	54.0	±0.015	108	85	22	94	±0.15	M10	8.5	56	0.080
75	S2B 50 N	50	+0.010 ~ -0.014	67.5	±0.015	135	102	27	116	±0.15	M12	10.5	72	0.400

SERIES S2B LME..

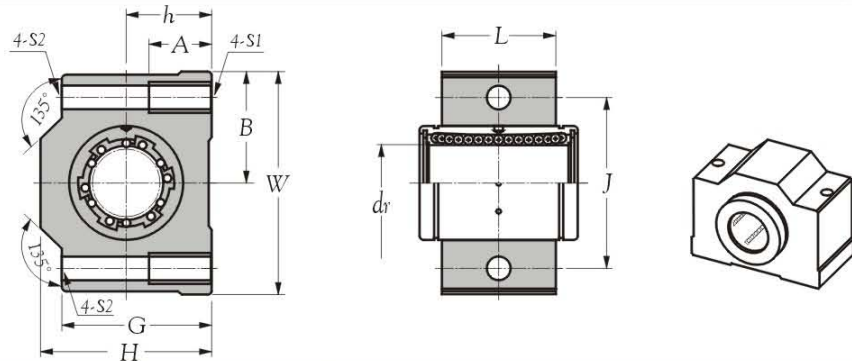

Boundary dimensions d mm	Bearing number	Principal dimensions										Mass kg (approx.)		
		h		B		W	H	A	J		S1		S2	L
		mm	0.001mm	mm	0.001mm	mm	mm	mm	mm	0.001mm	mm		mm	mm
22	S2B 12 N + LME 12 UU AS	20	+0.010 ~ -0.014	26.0	±0.015	52	38	13	42	±0.15	M6	5.3	20	0.025
26	S2B 16 N + LME 16 UU AS	20	+0.010 ~ -0.014	28.0	±0.015	56	40	13	46	±0.15	M6	5.3	22	0.060
32	S2B 20 N + LME 20 UU AS	25	+0.010 ~ -0.014	35.0	±0.015	70	50	15	58	±0.20	M8	6.6	28	0.098
40	S2B 25 N + LME 25 UU AS	30	+0.010 ~ -0.014	40.0	±0.015	80	60	18	68	±0.15	M8	6.6	40	0.125
47	S2B 30 N + LME 30 UU AS	35	+0.010 ~ -0.014	44.0	±0.015	88	70	18	76	±0.15	M8	6.6	48	0.140
62	S2B 40 N + LME 40 UU AS	45	+0.010 ~ -0.014	54.0	±0.015	108	85	22	94	±0.15	M10	8.5	56	0.080
75	S2B 50 N + LME 50 UU AS	50	+0.010 ~ -0.014	67.5	±0.015	135	102	27	116	±0.15	M12	10.5	72	0.400

Technical supplement

	Cages	Precision	Grease
	Steel - Nil		
	Polymid - Nil	Normal (ISO)	Nil
Brass - Nil			

Remark: If you have more inquiry of technical, please inquire
NIKO web-site: [Http://www.nipponkodobearings.com](http://www.nipponkodobearings.com)

ALUMINIUM HOUSINGS
SERIES **SBT..AS**

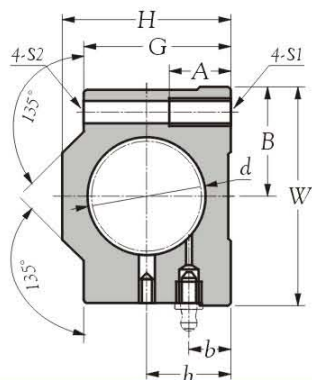

Boundary dimensions <i>d</i> mm	Bearing number	Principal dimensions											
		<i>h</i>		<i>B</i>		<i>W</i>	<i>H</i>	<i>b</i>	<i>A</i>	<i>J</i>		<i>S1</i>	<i>S2</i>
		mm	tolerance	mm	tolerance	mm	mm	mm	mm	mm	mm	mm	mm
22	SBT 12 AS	18	+0.010 ~ -0.014	21.5	±0.015	43	35	8	11	32	±0.15	M5	4.3
26	SBT 16 AS	22	+0.010 ~ -0.014	26.5	±0.015	53	42	12	13	40	±0.15	M6	5.3
32	SBT 20 AS	25	+0.008 ~ -0.016	30.0	±0.010	60	50	13	18	45	±0.15	M8	6.6
40	SBT 25 AS	30	+0.008 ~ -0.016	39.0	±0.010	78	60	15	22	60	±0.15	M10	8.4
47	SBT 30 AS	35	+0.008 ~ -0.016	43.5	±0.010	87	70	16	22	68	±0.15	M10	8.4
62	SBT 40 AS	45	+0.008 ~ -0.016	54.0	±0.010	108	90	26	26	86	±0.15	M12	10.5
75	SBT 50 AS	50	+0.005 ~ -0.016	66.0	±0.015	132	101	22	34	108	±0.15	M14	13.5

SERIES **SBT LME..**

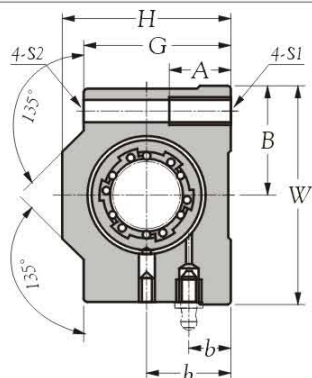

Boundary dimensions <i>d</i> mm	Bearing number	Principal dimensions											
		<i>h</i>		<i>B</i>		<i>W</i>	<i>H</i>	<i>b</i>	<i>A</i>	<i>J</i>		<i>S1</i>	<i>S2</i>
		mm	tolerance	mm	tolerance	mm	mm	mm	mm	mm	mm	mm	mm
22	SBT 12 AS + LME 12 UU AS	18	+0.010 ~ -0.014	21.5	±0.015	43	35	8	11	32	±0.15	M5	4.3
26	SBT 16 AS + LME 16 UU AS	22	+0.010 ~ -0.014	26.5	±0.015	53	42	12	13	40	±0.15	M6	5.3
32	SBT 20 AS + LME 20 UU AS	25	+0.008 ~ -0.016	30.0	±0.010	60	50	13	18	45	±0.15	M8	6.6
40	SBT 25 AS + LME 25 UU AS	30	+0.008 ~ -0.016	39.0	±0.010	78	60	15	22	60	±0.15	M10	8.4
47	SBT 30 AS + LME 30 UU AS	35	+0.008 ~ -0.016	43.5	±0.010	87	70	16	22	68	±0.15	M10	8.4
62	SBT 40 AS + LME 40 UU AS	45	+0.008 ~ -0.016	54.0	±0.010	108	90	26	26	86	±0.15	M12	10.5
75	SBT 50 AS + LME 50 UU AS	50	+0.005 ~ -0.016	66.0	±0.015	132	101	22	34	108	±0.15	M14	13.5

Technical supplement

	Cages	Precision	Grease
	Steel - Nil		
	Polymid - Nil	Normal (ISO)	Nil
	Brass - Nil		

Remark: If you have more inquiry of technical, please inquire
NIKO web-site: <http://www.nipponkodobearings.com>

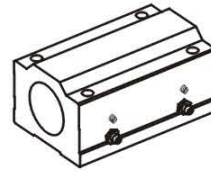
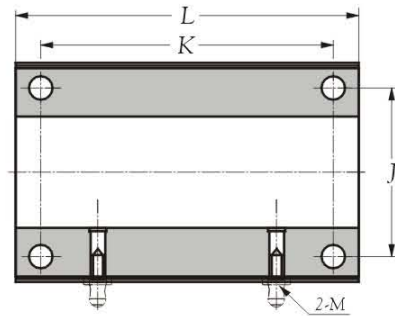

	Principal dimensions				Mass kg(s). (approx.)
	K tolerance mm	L	M	G	
56	±0.10	70	M6X1	31.0	0.170
64	±0.15	78	M6X1	37.0	0.310
76	±0.15	96	M6X1	44.0	0.486
94	±0.15	122	M8X1	52.5	0.630
106	±0.15	142	M8X1	62.5	0.760
124	±0.15	166	M8X1	80.0	0.980
160	±0.15	212	M8X1	88.0	2.360

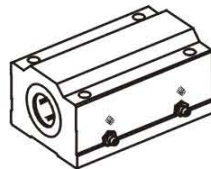
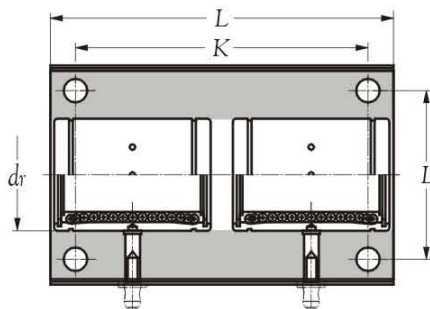

	Principal dimensions				Mass kg(s). (approx.)
	K tolerance mm	L	M	G	
56	±0.10	70	M6X1	31.0	0.170
64	±0.15	78	M6X1	37.0	0.310
76	±0.15	96	M6X1	44.0	0.486
94	±0.15	122	M8X1	52.5	0.630
106	±0.15	142	M8X1	62.5	0.760
124	±0.15	166	M8X1	80.0	0.980
160	±0.15	212	M8X1	88.0	2.360